

Courses & Distances

- N. 47. E. 130
- S. 63. E. 3
- N. 45. E. 95
- N. 34. W. 58
- N. 66. W. 89
- S. 56. W. 76
- West 20.1
- S. 62. W. 86
- S. 37. E. 95
- S. 32 1/2. E. 94 1/2

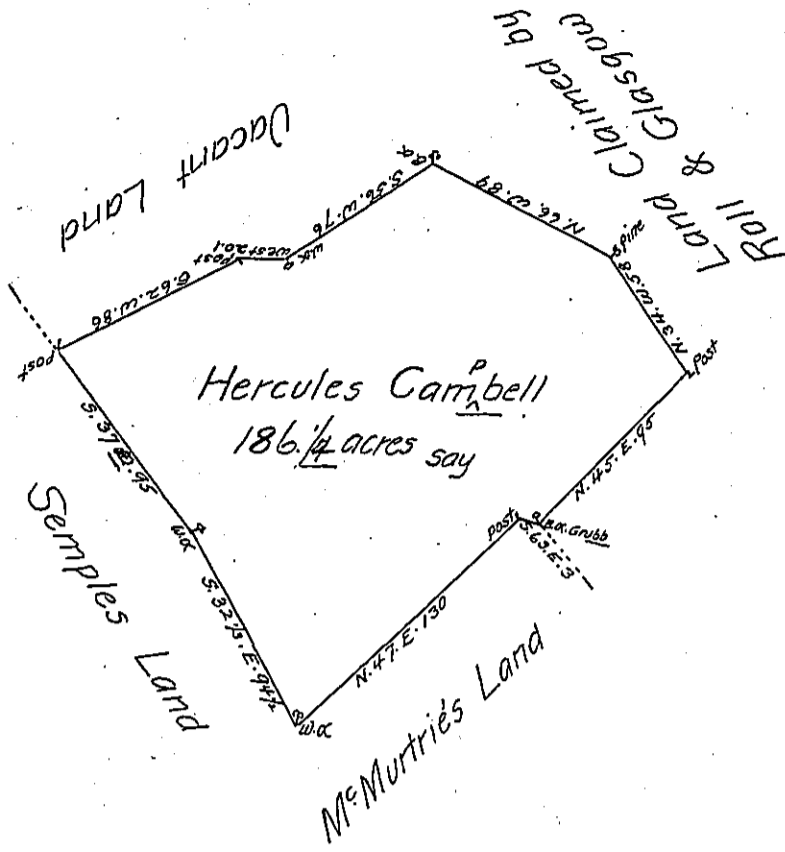

The Draught of a tract of land situate in Derry township,  
 Cumberland County, containing one hundred & eighty six acres & two tenths, &  
 the usual allowance of Six pr Cent for roads &c Surveyed for Hercules Camp-  
 bel, Decr the 24th. 1785 in pursuance of a warrant from the Honorable the  
 Vice President of the Supreme Executive Council, Dated, March the 4th. 1785

pr

Jas Harris D.S.

To John Lukens Esqr. Survr. General

IN TESTIMONY that the above is a copy of the original remaining on file in  
 the Department of Internal Affairs of Pennsylvania, made  
 conformably to an Act of Assembly approved the 16th day of  
 February, 1833, I have hereunto set my Hand and caused  
 the Seal of said Department to be affixed at Harrisburg,  
 this first day of June 1904

*Isaac P. Brown*  
 Secretary of Internal Affairs.